

Parts List and Assembly Diagram

Thank you for buying a quality above ground swimming pool from Wilbar!

We are providing you with this parts list and assembly diagram to assist you during installation and with the identification of parts should you ever need to order replacements. Use this sheet, along with the manual, to ensure proper location and assembly of all the parts of your pool.

Please read and understand this document completely before beginning the assembly of your pool. Also, make sure to save this sheet with your original purchase records. It contains vital information to assist us in identifying your pool should you ever need assistance.

Important Product Information

Description: 6500 Series Meadowbrook 52"

Aliases: Sandstone

Key Product Features:

- Sculpted Two Piece Easy Snap Seat Clamps
- ArmorCoat™ Wall and Poly-Enamel Coated Frame
- Artesian Wall Backer
- Z-BOLT Double-Track Wall Bolt Pattern

If your pool size is:	Your Complete Pool SKU # is:
12'	MB10A-52W-0012
15'	MB10A-52W-0015
18'	MB10A-52W-0018
21'	MB10A-52W-0021
24'	MB10A-52W-0024
27'	MB10A-52W-0027



WARNING! Shallow Water!
Absolutely NO DIVING or Jumping!
May cause Permanent injury or death.

Your pool is approximately 4 feet deep. It is not designed for jumping or diving. If you jump or dive into this pool, you run a high risk of permanent injury or death. Make sure all pool users, including guests, are aware of this, and point out all warning labels!



6500 Series Round

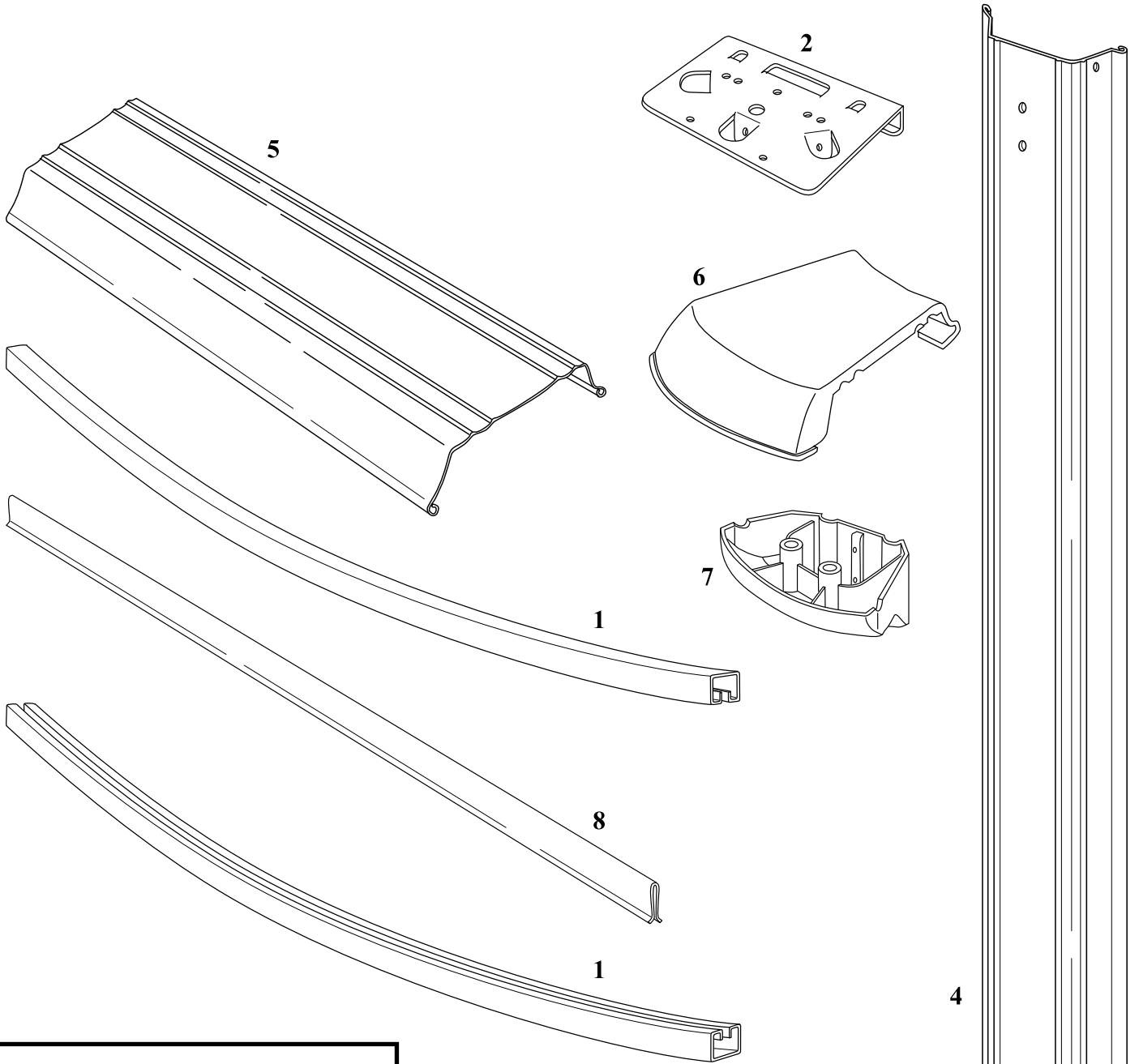

3

**Fastener
Pack**

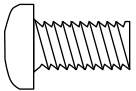

30246

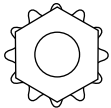

30256

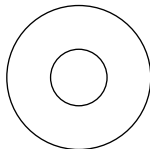

30257

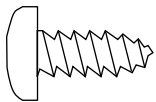

30253

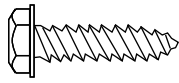

30365

*Hardware is shown
approximate actual size.*

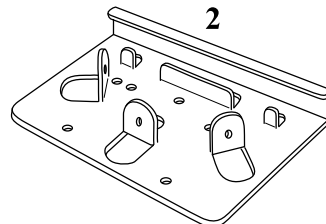

2

Product Family:	6500 52" Classic	Rev Date:	11/30/2007
Style: MB10A-52W	Round	Aliases: Meadowbrook, Sandstone	

Rim & Hardware 6500		Carton Code:		RH65-SSSS-XXXX					
	Description	Part Number	Length	12'	15'	18'	21'	24'	27'
1	Top & Bottom Rims	56458-298-04488	44 7/8"	20					
		56458-298-05106	51 1/16"		22				
		56458-298-05181	51 13/16"			26			
		56458-298-05238	52 3/8"				30		
		56458-298-05281	52 13/16"					34	
		56458-298-05313	53 1/8"						38
2	Top & Bottom Plates	56393-000-00000	N/A	20	22	26	30	34	38
	Homeowners Package	69802-000-00000	N/A	1	1	1	1	1	1
3	Fastener Packages	64002-000-00000	N/A	1					
		64003-000-00000	N/A		1				
	[These Part #s cover the entire fastener pack. Individ. parts are listed below.]	64004-000-00000	N/A			1			
		64005-000-00000	N/A				1		
		64006-000-00000	N/A					1	
		64007-000-00000	N/A						1
	<u>Fastener Pack Contents</u>								
	Bolt 1/4-20 x 1/2"	30246-440-00000	N/A	51	51	51	51	51	51
	Kep Nut 1/4-20	30256-440-00000	N/A	51	51	51	51	51	51
	Washer	30257-440-00000	N/A	102	102	102	102	102	102
	#14 5/8" Screw	30253-440-00000	N/A	88	104	120	136	152	168
	#10 3/4" Screw	30365-499-00000	N/A	40	44	52	60	68	76

Upright 6500		Carton Code:		U65-SGS52-XXXX					
	Description	Part Number	Length	12'	15'	18'	21'	24'	27'
4	Uprights	56440-365-05175	51 3/4"	10	11	13	15	17	19

Seat & Clamp 6500		Carton Code:		SC65-SGSGR-XXXX					
	Description	Part Number	Length	12'	15'	18'	21'	24'	27'
5	Seats	56467-365-04450	44 1/2"	10					
		56467-365-05150	51 1/2"		11	13			
		56467-365-05294	52 15/16"				15	17	19
6	Resin Clamp Top	31683-365-00000	N/A	10	11	13	15	17	19
7	Resin Clamp Base	31684-365-00000	N/A	10	11	13	15	17	19

Wall 52" Meadowbrook		Carton Code:		U65-SGS52-XXXX					
	Description	Part Number	Length	12'	15'	18'	21'	24'	27'
8	Wall 52" Classic	1252-MB-LG	37' 8-3/8"	1					
		1552-MB-LG	47' 1-7/16"		1				
		1852-MB-LG	56' 6-9/16"			1			
		2152-MB-LG	65' 11-5/8"				1		
		2452-MB-LG	75' 4-3/4"					1	
		2752-MB-LG	84' 9-7/8"						1
	Coping	33789-299-00000	48"	10	12	15	17	19	22